

# M2S

## instrument manifold (direct)

### specifications

Two valve manifold M2S combines facilities for isolation, calibration, testing and venting of instruments.

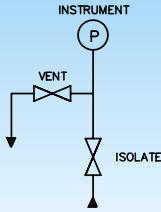

body	stainless steel
inlet (1x)	horizontal 1/2" npt female at bottom side
outlet (1x)	horizontal 1/2" npt female at top side
vent/test connection	at front side
venting bonnet	at left hand side
isolating bonnet	at right hand side
stem	type HS, conical metal end tip with PTFE gland packing
pressure in bar	420

options:	stem type SO (max. pressure 400 bar) high temperature up to 550 °C high pressure up to 700 bar anti tamper facility with removable T-bar key
----------	---

Detailed drawing available on request.

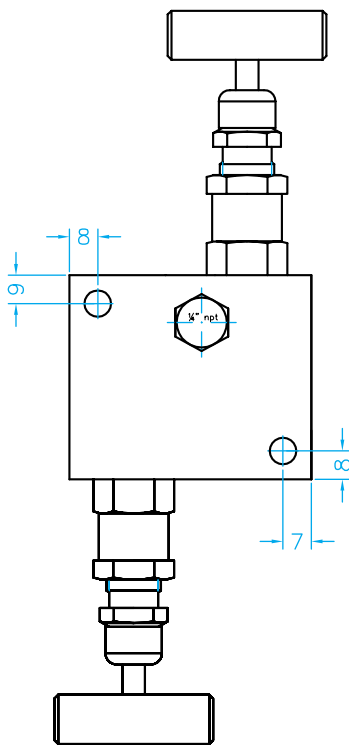

front view

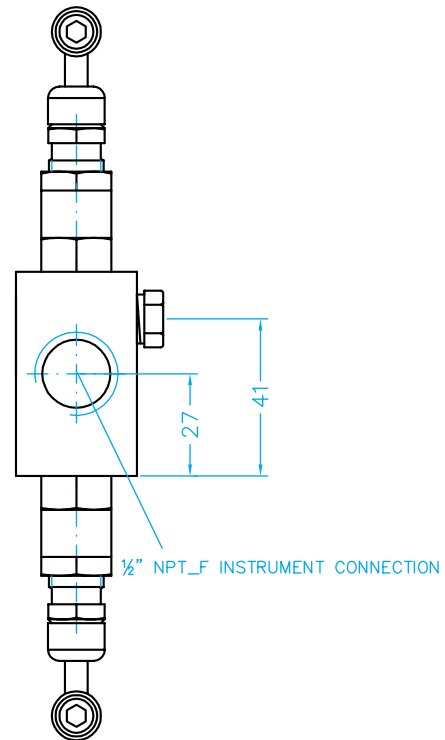

side view

type	in x out	thread type	body	stem	packing
M2S	1/4" x 1/4" 3/8" x 3/8" 1/2" x 1/2"	npt bsp	Carbon steel AISI 304 AISI 316 AISI 316L Monel Hastelloy C	HS SO	PTFE glass filled PTFE grafoil