

# M2K

## instrument manifold (direct)

### specifications

Model M2K is a compact two valve manifold to accommodate any full DIN 19213 interface compliant pressure transmitter.

body	stainless steel
inlet (1x)	flanged to fit DIN 19213
outlet (1x)	flanged to fit DIN 19213
vent/test connection	at front side plugged
venting bonnet	at right hand side
isolating bonnet	at top side
stem	type HS, conical metal end tip with PTFE gland packing
pressure in bar	420

options:	high temperature up to 550 °C high pressure up to 700 bar anti tamper facility with removable T-bar key
----------	---

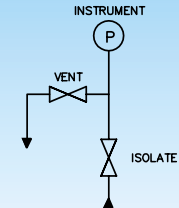

Detailed drawing available on request.

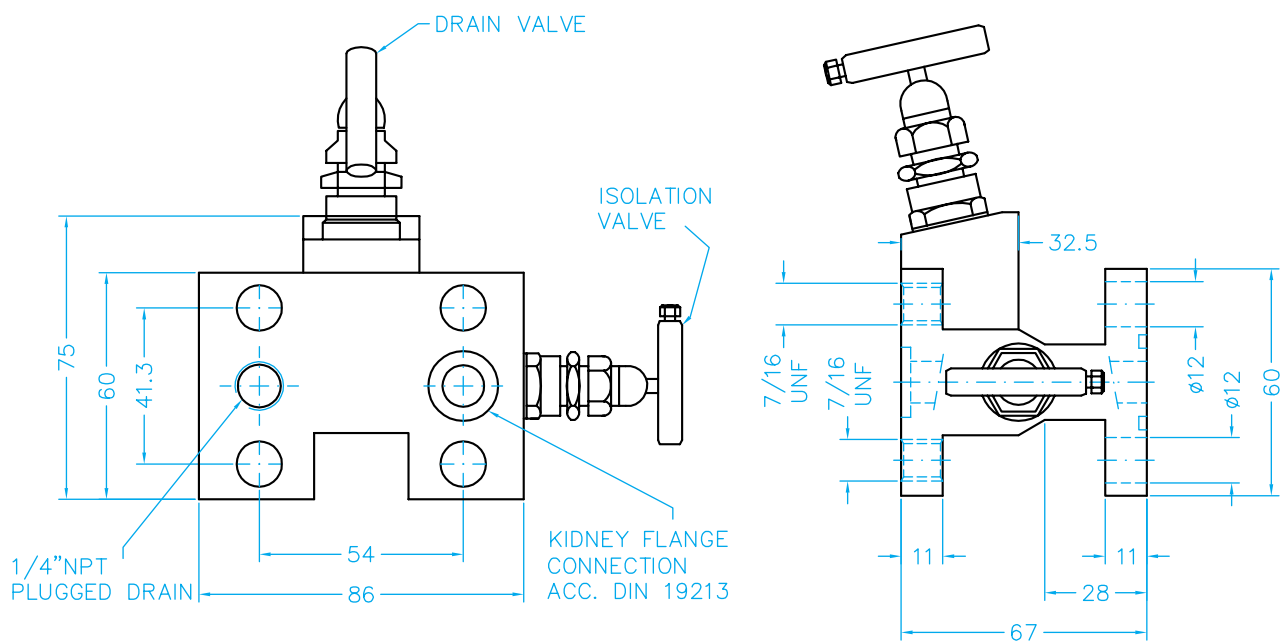

front view

side view

MESC code 10mm O.D. fitting: 60.98.56.225.1  
MESC code 3/8" O.D. fitting: 60.98.56.227.1

type	in x out	thread type	body	stem	packing
M2K	flange x flange		Carbon steel AISI 304 AISI 316 AISI 316L Monel Hastelloy C	HS SO	PTFE glass filled PTFE grafoil

extra to order: mounting pack 7/16" UNF bolts and PTFE gaskets