

M5S

instrument manifold (direct)

specifications

Five valve manifold model M5S is designed for complete isolation of instruments and can be directly mounted on differential pressure transmitters.

body	stainless steel
inlet (2x)	1/2" npt female
outlet (2x)	flanged DIN 19213
vent/test connection	at bottom side
equalizing bonnet	angular on top side
isolating bonnet (2x)	angular on top side
venting bonnet (2x)	at left and right hand side
stem	type HS, conical metal end tip with PTFE gland packing
pressure in bar	420
options:	stem type SO (max. pressure 400 bar) high temperature up to 550 °C high pressure up to 700 bar anti tamper facility with removable T-bar key

Detailed drawing available on request.

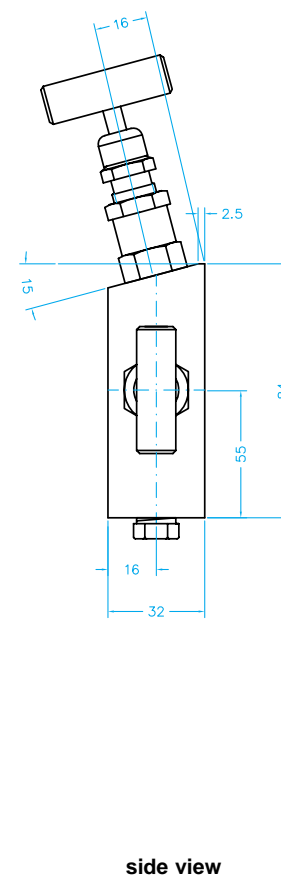
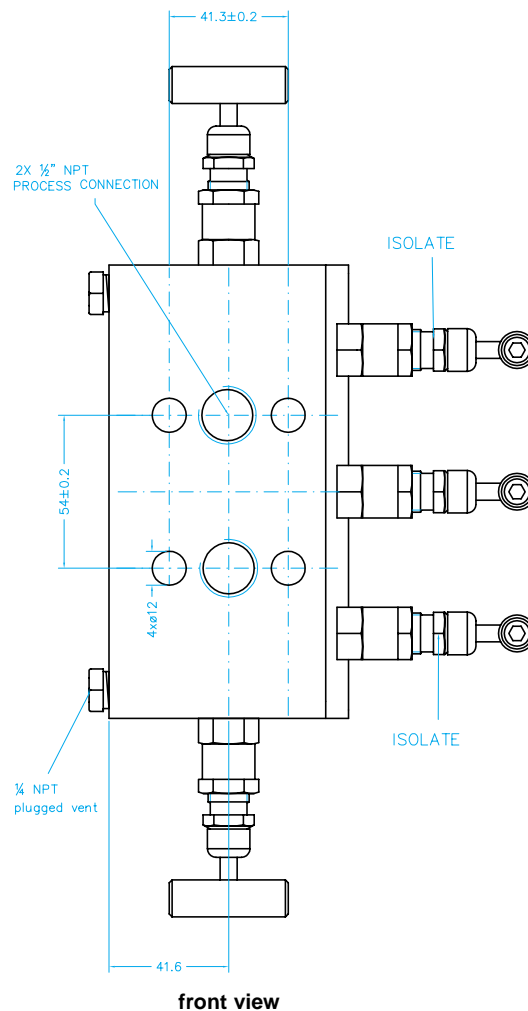
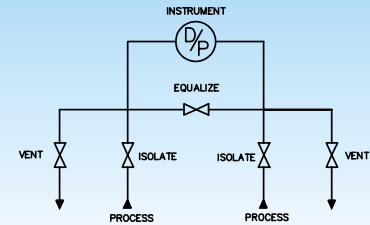

type	in x out	thread type	body	stem	packing
M5S	1/4" x flanged 3/8" x flanged 1/2" x flanged	npt bsp	Carbon steel AISI 304 AISI 316 AISI 316L Monel Hastelloy C	HS SO	PTFE glass filled PTFE grafoil

extra to order: mounting pack 7/16" UNF bolts and PTFE gaskets